

POMPANO BEACH FISHING VILLAGE PARKING SUMMARY			
PER ADD CODE SECTION 155.3703.E.2.a			
	ADD CODE	REQUIRED	TOTAL
	REQUIRED	SPACES PER	REQUIRED
REQUIRED PARKING	S.F.	S.F. OR UNIT	SPACES
NON-RESIDENTIAL	8,366	0.001	9
RESIDENTIAL	0	0	0
<b>TOTAL REQUIRED</b>			<b>9</b>
PROVIDED PARKING			
PARKING STRUCTURE			613
ON SITE - STREET N. POMP. BCH. BLVD			0
ON SITE - PIER STREET			2
ON SITE - (WESTERN SIDE OF LOT) STREET			8
ON SITE - (WESTERN SIDE OF LOT) STREET			8
<b>TOTAL PROVIDED</b>			<b>631</b>
<b>EXCESS (DEFICIENCY)</b>			<b>610</b>

NOTE: PARKING CALCULATIONS APPLY TO AREAS OF POMPANO BEACH FISHING VILLAGE LOCATED BOTH EAST AND WEST OF POMPANO BEACH BOULEVARD.

**LEGEND**

- EXISTING DUNE TO REMAIN
- PROPOSED DUNE ENHANCEMENTS
- PROPOSED LANDSCAPE ENHANCEMENTS

**KEY NOTES**

**GA**  
**GONZALEZ ARCHITECTURE**  
 4304 NE 2ND AVENUE  
 MIAMI FLORIDA 33137  
 T: 305.440.4314  
 F: 866.443.1486  
 E: create@gonzalezarchitecture.com

**ENGINEERS OF RECORD**  
**CREDO CONSULTING ENGINEERS, LLC**  
 800 E BROWARD BLVD., SUITE 601  
 FORT LAUDERDALE, FL 33301  
 PHONE: 954.783.2246  
 FAX: 954.783.2247  
 WWW.CREDO-ENGINEERS.COM

**MUENGINEERS, INC.**  
 3440 NE 12TH AVENUE  
 OAKLAND PARK, FL 33334  
 PHONE: 954.324.4730  
 CAR: 29348  
 WWW.MUENGINEERS.COM

**SEAL / SIGNATURE**

ENRIQUE RENE GONZALEZ

STATE OF FLORIDA  
 REGISTRATION #RS4718

**DRAWING ISSUE**  
 11-20-17 PERMIT ISSUE  
 01/10/2018 BLDG. DEPT. COMMENTS

**COMMERCIAL SHELL BLDG.**  
 PARCEL R2  
 245 N. POMPANO BEACH BOULEVARD  
 POMPANO BEACH, FLORIDA 33062

**SHEET NOTES**

- ALL CONTRACTORS SHALL FIELD MEASURE AND VERIFY ALL DIMENSIONS.
- ALL CONTRACTORS SHALL COMPLY WITH APPLICABLE LOCAL, STATE AND FEDERAL BUILDING CODES.
- APPLICABLE PERMIT SHALL BE POSTED ON SITE AT ALL TIMES.
- GO TO PROVIDE SHOP DRAWINGS FOR ALL SPECIALTY WORK, INCLUDING BUT NOT LIMITED TO WINDOWS, STEEL, MILLWORK ETC.
- ALL WORK TO COMPLY WITH: FLORIDA BUILDING CODE 2014, FLORIDA ACCESSIBILITY CODE 2014, NFPA 70 - NATIONAL ELECTRICAL CODE, FLORIDA FIRE PREVENTION CODE 2012 EDITION, NFPA 101 LIFE SAFETY CODE, NFPA 72 NATIONAL FIRE ALARM CODE.

**DESCRIPTION**

SITE PLAN

SCALE: 1/8"=1'-0"

**SHEET**

**A0.3**

© 2016 Gonzalez Architecture PA.

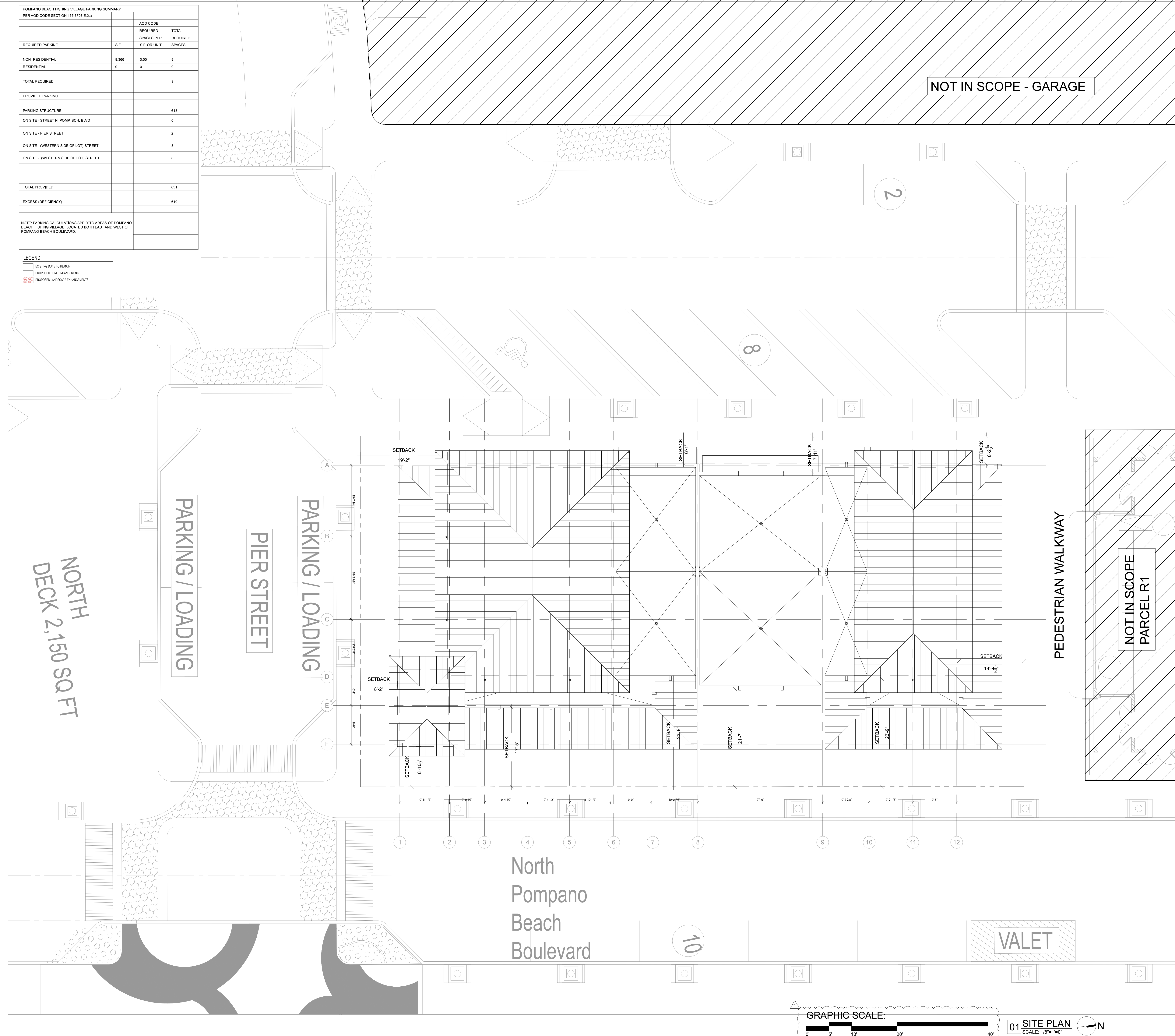

NOT IN SCOPE - GARAGE

NOT IN SCOPE PARCEL R1

VALET

**GRAPHIC SCALE:**

0 5' 10' 20' 40'

**01 SITE PLAN**  
 SCALE: 1/8"=1'-0"

N